

# IDEAL STANDARD - MOMENTS VANITY BASIN

## INSTALLATION INSTRUCTIONS

- 1 Cut out bench top as per template supplied.

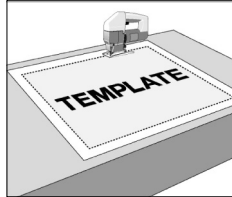

- 2 Fit selected tapware and waste to basin. Ensure waste is siliconed around rim.

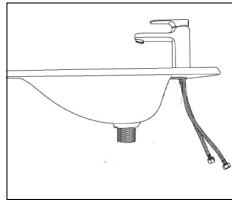

- 3 Apply waterproof sealant to rim of basin and locate basin complete with fittings onto bench top and press firmly all around.

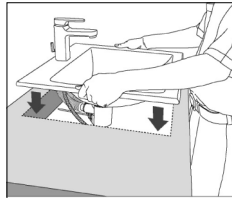

- 4 If desired all visible external edges can be joint sealed using flexible sealant ensuring to wipe off any excess.

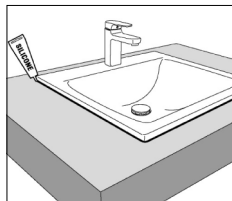

## WARRANTY

Dear Customer,

This is the warranty by Reece Pty. Ltd. relating to this product. Please keep it together with your purchase receipt. In the unlikely event of a query please contact your nearest Reece Plumbing Centre.

### Warranty

You have purchased a quality product from Reece Australia. This product is covered by a twelve month warranty. This warranty covers faults in the product construction, material and assembly. Faulty products will be repaired or exchanged free of charge. Faulty items become our property.

This warranty does not include faults caused by:

- Unsuitable or improper use
- Incorrect installation
- Installation or part installation by the purchaser or any person other than a LICENSED PLUMBER or tradesman
- Normal wear and tear
- Inadequate or complete lack of maintenance
- Chemical, electrochemical or electrical influences.

### Cleaning Recommendations

Any sanitaryware should not be cleaned with abrasive materials eg steel wool/scourers. Do not use any corrosive or abrasive cleaning agents containing acids or scouring agents.

In the event of a warranty claim, we will replace or repair defective products, or pay for the cost of having defective products repaired or replaced, but will not be liable for any injury to any person, damage to any property, any indirect or consequential loss, or in any other respect.