

- 1 # 2700700000 ●
  - 2 # 2700700030 ●●●
  - 3 # 2700600000 ●●●
  - 4 # 2700600030 ●●●
  - 5 # 0858100000 ●
- 1 # 2700700000 ●
  - 2 # 2700700030 ●●●
  - 3 # 2700600000 ●●●
  - 4 # 2700600030 ●●●
  - 5 # 0858120000 ●
- 1 # 0720500000 ●
  - 2 # 0858130000 ●
- 1 # 0370700000 ☒
- 1 # 0371100000 ●
  - 2 # 0371100030 ●●●

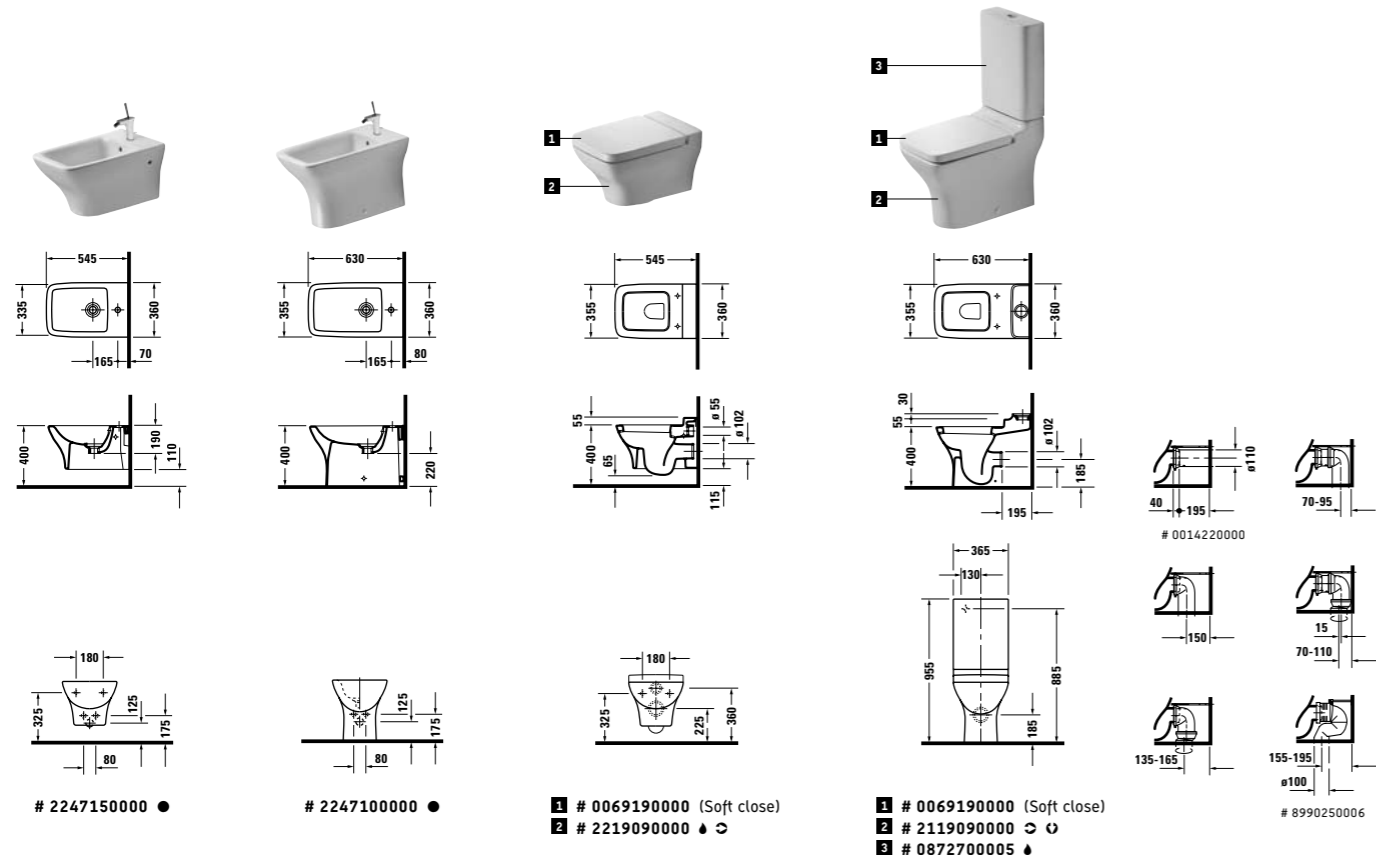

X Genaues Maß durch Unterstellen der Säule ermitteln. To determine height please set washbasin on pedestal.  
 Définir les dimensions exactes par rapport au positionnement de la colonne. Precizie maten t.o.v. de plaatsing van de zuil aangeven.  
 Determinare l'altezza esatta posizionando la colonna sotto il lavabo. La altura de fijación se determina poniendo el pedestal por debajo del lavabo  
 Bei Verwendung des Siphon # 0050361000. With usage of design siphon # 0050361000. Pour l'utilisation du siphon design # 0050361000.  
 Als de designsiphon # 0050361000 gebruikt wordt. Se si utilizza il sifone # 0050361000. Utilizando el sifón de diseño # 0050361000  
 ☒ Kein Hahnloch (glatt). Without tap hole. Sans trou. Zonder kraangat. Nessun foro. Sin agujero para grifería  
 ●●● Hahnloch durchgestochen. Tap hole punched. Trou percé. Kraangat doorgestoken. Monoforo. 1 agujero para grifería hecho  
 ●●● 3 Hahnlöcher durchgestochen. 3 tap holes punched. 3 trous percés. 3 Kraangaten doorgestoken. 3 fori. 3 agujeros para grifería hechos  
 ○ Abgang vertikal. Vertical outlet. Sortie verticale. Afvoer verticaal. Scarico verticale. Desagüe vertical  
 ⊙ Abgang horizontal. Horizontal outlet. Sortie horizontale. Afvoer horizontaal. Scarico orizzontale. Desagüe horizontal  
 ● Steht für alle WCs und Spülkästen, die mit 6 Liter Spülwassermenge auskommen. Economical 6-liter flush.  
 Ce symbole accompagne les réservoirs et cuvettes permettant un rinçage économique avec seulement 6 litres d'eau.  
 Staat voor alle wc's en reservoirs, die met 6 ltr. kunnen spoelen. Per vasi e cassette con sciacquo a 6 litri. Cisterna e inodoro de consumo económico de 6 litros  
 ↗ Tiefe. Depth. Profondeur. Diepte. Profundità. Profundidad  
 L/R Links/Rechts. Left/Right. Gauche/Droite. Rechts/Links. A sinistra/A destra. Izquierda/Derecha  
 ☉ Mit Beleuchtung. With lighting. Avec éclairage. Met binnenverlichting. Con illuminazione. Con iluminación

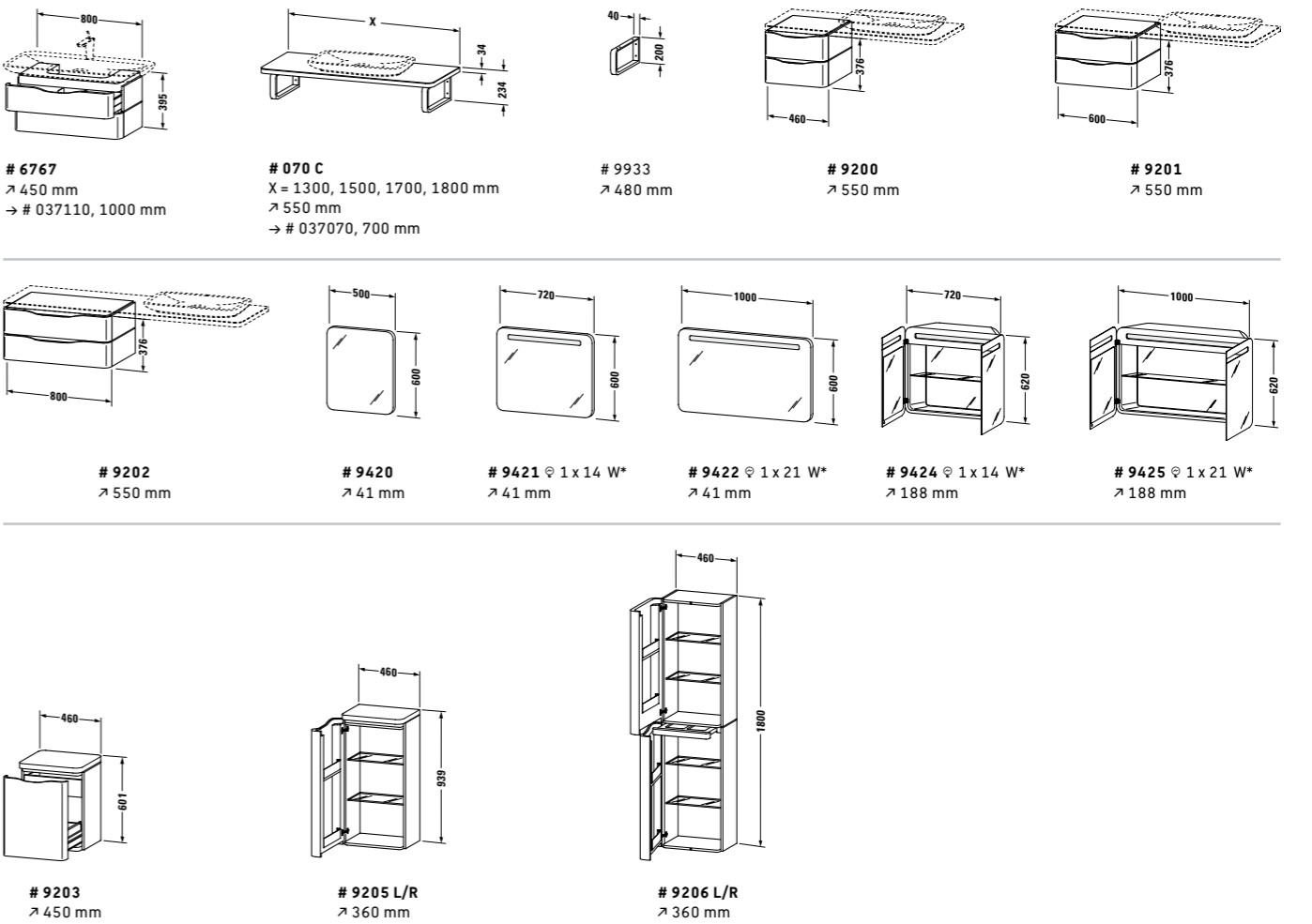

\* Leuchtstoffröhre. Fluorescent tubes. Tubes fluorescents. TL-lampen. Lampada al neon. Tubo fluorescente

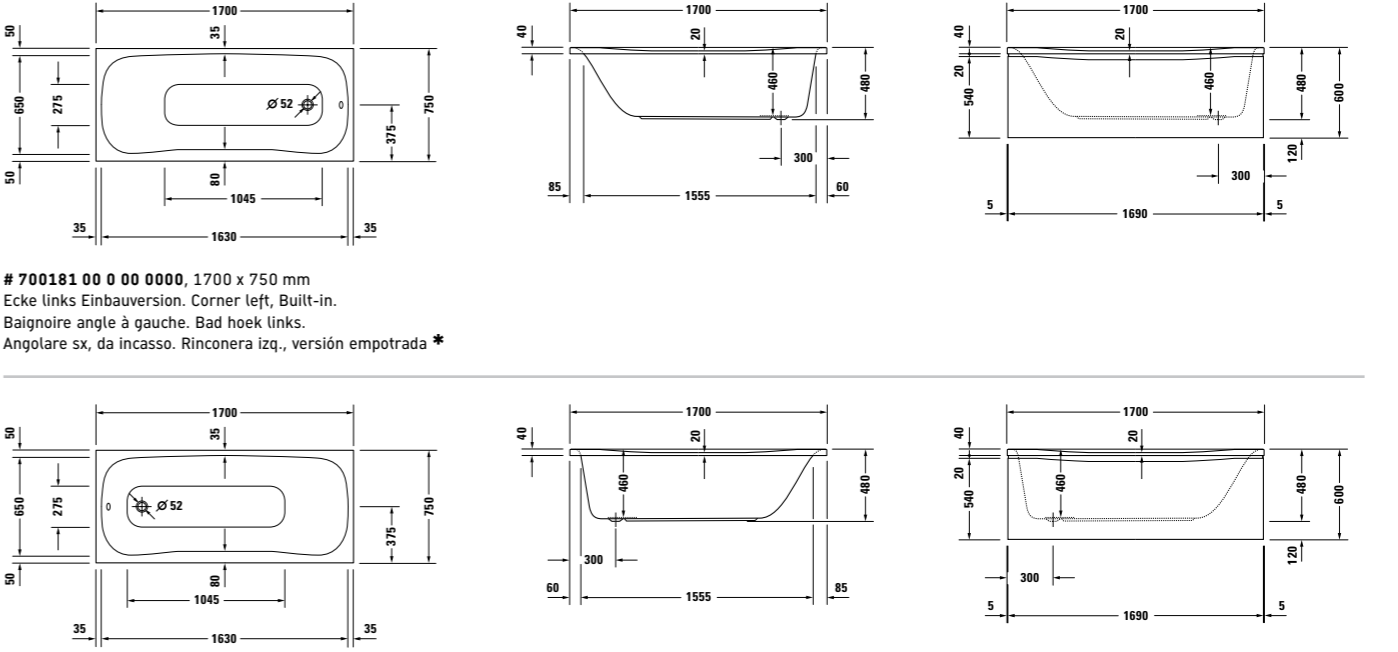

# 700181 00 0 00 0000, 1700 x 750 mm  
 Ecke links Einbauversion. Corner left, Built-in.  
 Baignoire angle à gauche. Bad hoek links.  
 Angolare sx, da incasso. Rinconera izq., versión empotrada \*

# 700198 00 0 00 0000, 1700 x 750 mm  
 Ecke rechts Einbauversion. Corner right, Built-in.  
 Baignoire angle à droite. Bad hoek rechts.  
 Angolare dx, da incasso. Rincón dcha., versión empotrada \*

\* Passende Möbelverkleidungen siehe aktuelle Preisliste. Suitable furniture panels see current pricelist. Habillages façon meuble correspondants voir le tarif en vigueur.  
 Passende meubelommanteling zie prijslijst. Per i pannelli di rivestimento abbinati vedere il listino prezzi in vigore.  
 Para los correspondientes revestimientos, por favor mire la lista de precios general en vigor

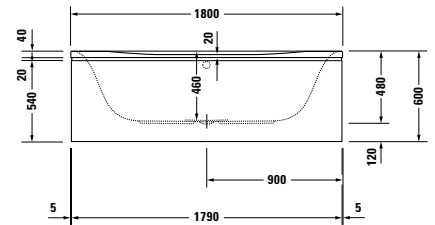
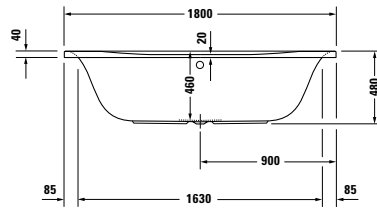
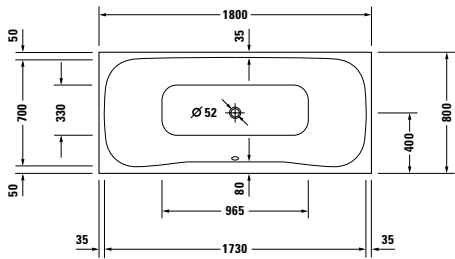

# 700182 00 0 00 0000, 1800 x 800 mm  
Einbauversion. Built-in. Inbouwversie.  
Version à encastrer. Da incasso. Versión empotrada \*

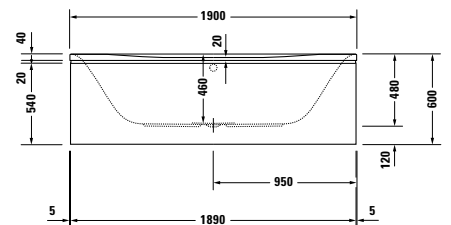
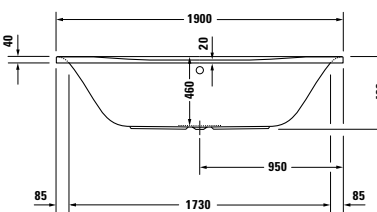
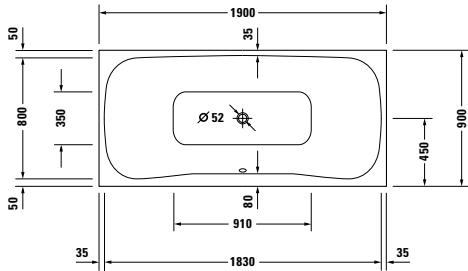

# 700183 00 0 00 0000, 1900 x 900 mm  
Einbauversion. Built-in. Inbouwversie.  
Version à encastrer. Da incasso. Versión empotrada

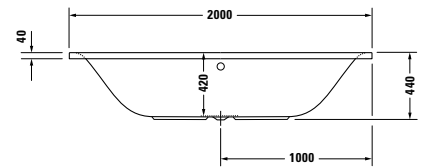
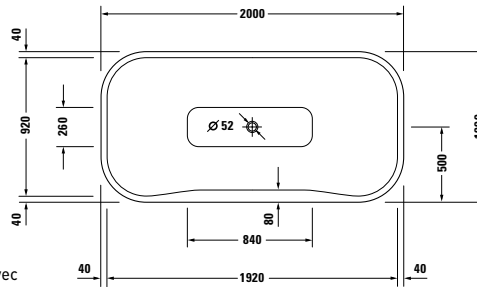

# 700184 00 0 00 0000, 2000 x 1000 mm  
Aufbauversion. Lay-on version. Version à encastrer avec rebord haut. Opbouwversie met hoge rand. Versione da incasso con bordo alto e arrotondato. Con borde alto

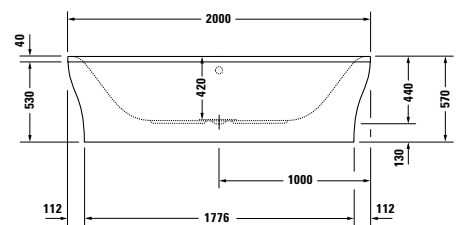
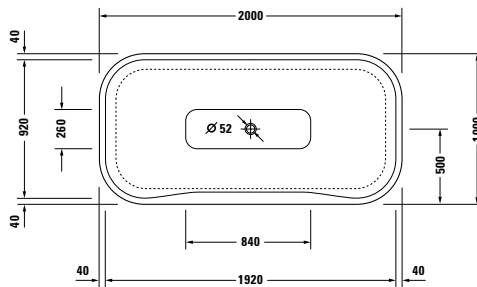

# 700185 00 0 00 0000, 2000 x 1000 mm  
Freistehende Version. Freestanding. A poser en îlot. Vrijstaand. A centro stanza. Exenta

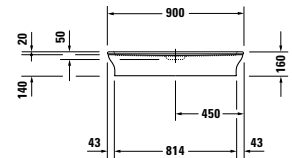
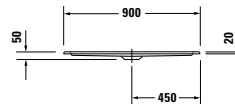
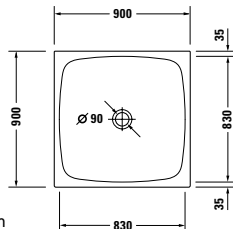

# 720077 00 0 00 0000, 900 x 900 mm

Ohne Schürze. Without panel.  
Sans tablier. Zonder paneel.  
Senza pannello. Sin faldón

Mit Schürze. With panel.  
Avec tablier. Met paneel.  
Con pannello. Con faldón

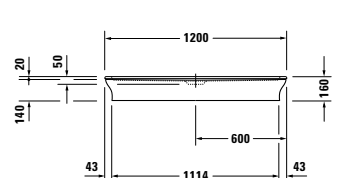
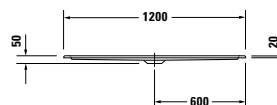
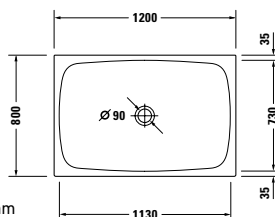

# 720078 00 0 00 0000, 1200 x 800 mm

Ohne Schürze. Without panel.  
Sans tablier. Zonder paneel.  
Senza pannello. Sin faldón

Mit Schürze. With panel.  
Avec tablier. Met paneel.  
Con pannello. Con faldón